

DESCRIPTION

HEDGE-8016-C200 16-Channel GNSS CRPA is a multi-band, multi-array solution designed for advanced interference suppression and assured GNSS reception.

Support for multiple GNSS constellations and signals ensures high availability and robust tracking performance in contested interference environments, making the solution suitable for platforms requiring high-end interference mitigation capability.

KEY FEATURES

- L1, L2, L5 Band Support
- Multi-Frequency & Multi-Constellation GNSS Reception
- Up to 7 Different Jammer Suppression on Each Band
- Adaptive Notch Filters & Pulse Blankers
- Real Time Monitoring and Configuration in WebGUI
- Virtual Antenna Pattern Visualization
- FFT Spectrum Viewer
- Jammer Signal Information
- Embedded GNSS Receiver

APPLICATION AREAS

- Commercial Drones & UAVs
- Marine
- Autonomous Vehicles / Robotics
- Telecom Infrastructure

TECHNICAL SPECIFICATIONS

- Antenna Array : 8 + 8 Element
- Simultaneous Independent Nulling: 7 + 7
- Nominal Jammer Suppression: > 50 dB
- J/S Performance: > 115 dB (with GNSS receiver)
- Frequency Bands: L1C, L1C/A, E1, B1C, B1I
L2C, L2P(Y), E5b, B2b, B2I
L5, E5a, B2a
- Operating Voltage: 9-36 V DC
- Power Consumption: < 25 W

INTERFACE SPECIFICATIONS

- Interfaces: Ethernet, RS-485, RS-232
- Connectors: 1x SMA, 1x Micro-D

MECHANICAL SPECIFICATIONS

- Dimensions: $\varnothing 200 \times 38$ mm
- Weight: < 1300g

ENVIRONMENTAL SPECIFICATIONS

- Operating Temperature: -40°C to +85°C
- Environmental Compliance: MIL-STD-810H
- EMC Compliance: MIL-STD-461F

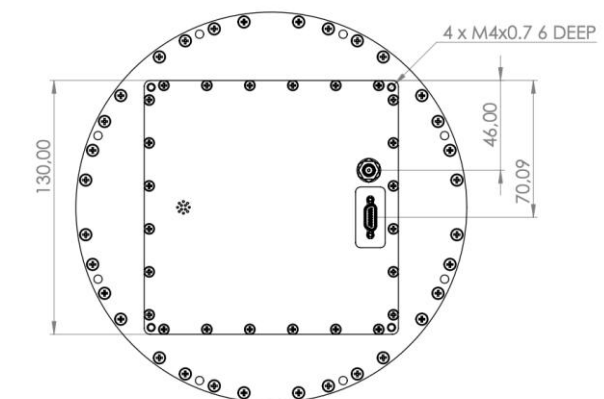
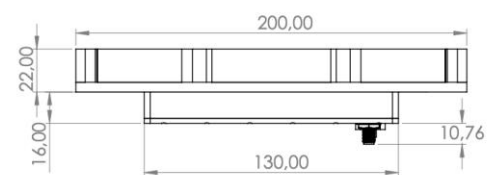
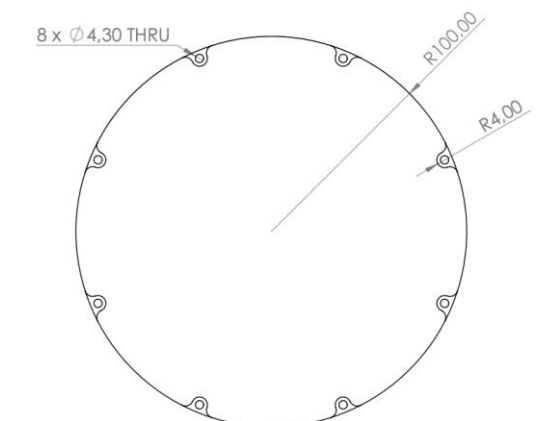
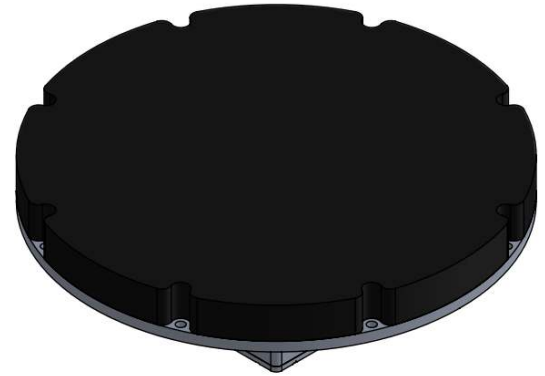

Unless otherwise specified dimensions are in millimeters.